

# The Wadesmill Suite



## Funeral Buffets

---

Wodson Park Sports & Leisure Centre, Wadesmill Road, Ware, Hertfordshire, SG12 0UQ  
Registered Charity No: 1101130 | Company Registration No: 04757847 | Company VAT No: 875541203  
Tel: 01920 487 091 | website: [www.wodsonpark.com](http://www.wodsonpark.com)

## **The Wadesmill Suite**

### **Funeral Buffets**



At Wodson Park, we appreciate that planning funeral arrangements is a difficult time for families, with so many decisions to make, often at short notice.

We can help make the catering part of your funeral arrangements as easy and stress-free as possible for you, by offering

- the assistance of our professional, sympathetic staff team who will help you wherever we possibly can, to meet your specific needs and wishes;
- a caring and understanding welcome for you and your guests to a warm private room - within our Old Charm Bar or Wadesmill Suite;
- a discreet, catering service;
- a choice of Buffet Menus including Tea and Coffee – we can cater for special dietary requirements and all of our menus can be adapted to suit your budget;
- a wide selection of drinks and spirits from our Licensed Bar;
- ample free parking.

We will be pleased to show you our Old Charm Bar and our Wadesmill Suite facilities and discuss your specific Funeral Buffet catering arrangements over a cup of tea or coffee. Please contact us to make an appointment.

### **The Old Charm Bar**

The Old Charm Bar can seat a maximum of 30 people, and thus is an ideal, intimate space for you to host a small Funeral Buffet.

Gatherings of over 30 people may be easily accommodated within our flexible Wadesmill Suite.

# The Wadesmill Suite

## Funeral Buffets



### The Wadesmill Suite

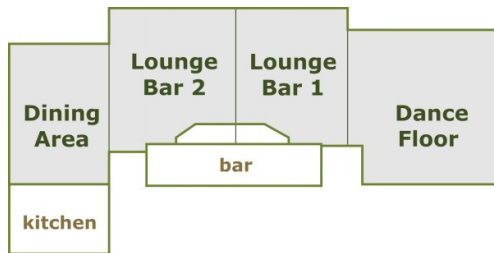

#### The Wadesmill Suite

at Wodson Park is a large, flexible space, which may be opened up to create one large room, or partitioned to create smaller, more intimate areas.

Our most popular Wadesmill Suite room combinations for Funeral Buffets are shown within the Table below.

The Wadesmill Suite		
Popular Funeral Buffet Room Options	Maximum Capacity (People)	
	Informal	Conference
2	100	56
3	80	40
6	150	100
7	240	150

The Wadesmill Suite includes two well-stocked bars. If we don't hold a particular alcoholic or non-alcoholic drink or spirit that you require for your Funeral Buffet, we can usually obtain it for you from our suppliers.

**The Wadesmill Suite**  
**Funeral Buffets**  
**Lily Buffet Menu**



We offer three Funeral Buffet Menus  
(named after three flowers: Lily, Rose and Iris)  
to help make your catering choices that little bit easier.

**Lily Buffet Menu**

**Lily Buffet - £5.00 per head**

**Selection of Sandwiches**

*tuna and cucumber, egg and cress,  
cheese salad, and gammon ham  
on farmhouse, granary and wholemeal bread*

**Cocktail Chicken Satays**

**Selection of Crolines**

*bite size puff pastries  
filled with mushroom and ham, cheese, and salmon*

**Cocktail Sausages**

*coated in honey and mustard*

**Selection of Homemade Cakes**

**Tea and Coffee**

**The Wadesmill Suite**  
**Funeral Buffets**  
**Rose Buffet Menu**



**Rose Buffet - £7.50 per head**

**Selection of Sandwiches**

*tuna and cucumber, egg and cress,  
cheese salad, and gammon ham  
on farmhouse, granary and wholemeal bread*

**Tomato and Basil Bruschetta**

**Cocktail Chicken Satays**

**Selection of Crolines**

*bite size puff pastries  
filled with mushroom and ham, cheese, and salmon*

**Cocktail Sausages**

*coated in honey and mustard*

**Mini Savoury Tartlets**

*open tartlets filled with brie and grape,  
salmon mousse, roasted vegetables*

**Indian Selection**

**Vegetable Crudités and Dips**

*houmous, sour cream and chive and salsa dips  
served with tortilla chips and breadsticks*

**Selection of Homemade Cakes and Cookies**

**Tea and Coffee**

**The Wadesmill Suite**  
**Funeral Buffets**  
**Iris Buffet Menu**



**Iris Buffet - £10.50 per head**

**Selection of Open Bridge Rolls**

**Tomato and Basil Bruschetta**

**Cocktail Chicken Satays**

**Selection of Crolines**

*bite size puff pastries  
filled with mushroom and ham, cheese, and salmon*

**Cocktail Sausages**

*coated in honey and mustard*

**Filo Baskets**

*bite size filo pastries  
filled with sweet peppers and cream cheese*

**Tempura King Prawns**

**Vegetable Crudités and Dips**

*houmous, sour cream and chive, and salsa dips  
served with tortilla chips and breadsticks*

**Cheese Board**

*selection of English cheeses  
served with crackers, celery and pickles*

**Selection of Homemade Cakes and Cookies**

**Fresh Fruit Platter**

**Tea and Coffee**





## Contact Us

### Our Address

Wodson Park Sports and Leisure Centre  
Wadesmill Road  
Ware  
Hertfordshire  
SG12 0UQ

### Telephone

01920 487 091

### Website (including our e-mail contact form)

[www.wodsonpark.com](http://www.wodsonpark.com)

### Opening Hours

Mon - Fri : 7am - 10pm

Saturday : 8am - 8pm

Sunday : 9am - 9pm